

**SAAB**

SERVICE INFORMATION

SI No. 432-2024	Date November 1998	900
PI No.	Distr. all	

Improved bush and gear linkage

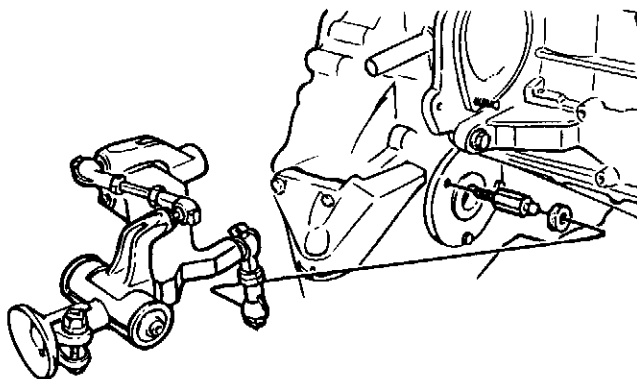

D432B615

Cars affected

Saab 900 M94-96 with manual, alternatively Sen-sonic gearbox

Background

A problem may occur with the gear shifting on cer-tain cars that makes it difficult to change gear. This is caused by a bush connecting the front gear rod with the gear linkage breaking under stress. The problem has been especially evident on cars that have been driven hard and aggressively in warm climates.

The solution is to install an improved linkage assem-bly.

Parts required

- 46 26 321 Linkage (CA: 30579660)
- 46 26 677 Ball stud (CA: 30564619)
- 46 26 537 Seal (CA: 30564607)

Saab Automobile AB Bulletins are intended for use by professional Saab technicians only, NOT a "do-it-yourselfer". They are designed to inform these technicians of conditions that may occur on some vehicles, or to provide information that could assist in the proper service of a vehicle. Saab trained technicians have the equipment, tools, safety instructions, and know-how to do a job properly and safely. If a condition is described, DO NOT assume that the bulletin applies to your vehicle, or that your vehicle will have the condition. See your authorized Saab Dealer for information on whether your vehicle may benefit from the information.
© 1998 Saab Automobile AB. All rights reserved.

ENG

- 8 Remove the rubber boot above the "lug".
- 9 Saw off the "lug" containing the plastic bush in the rear engine mounting.
File off any burrs.

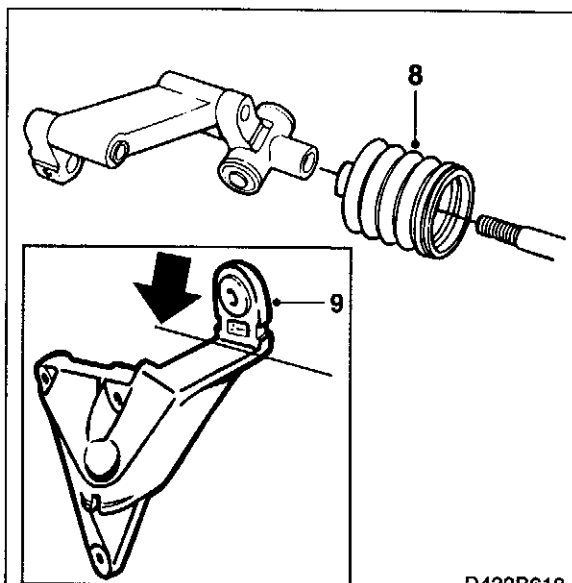

D432B618

- 10 Remove the top rear screw on the seal retainer with Torx key 40.
- 11 Fit the ball stud into the screw hole.
Tightening torque: 22 Nm (16 lbf ft)
- 12 Fit the seal.
- 13 Position the new gear linkage on the gear rod in the gearbox.
- 14 Position the ball stud and apply the lock mechanism.
- 15 Lower the car
- 16 Screw together the gear linkage with the gear rod in the gearbox.
Tightening torque: 22 Nm (16 lbf ft)

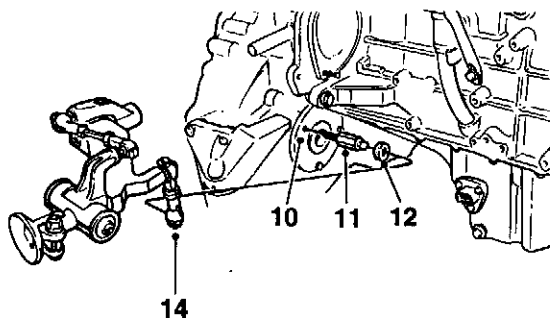

D432B619

- 17 Lift up the gear lever boot with surround.
- 18 Engage 4th gear and insert lock pin 87 92 335 into the gear shift housing with the ring up.
- 19 Tighten the nut on the clamp by the gear rod. Use a 13 mm spanner.
Tightening torque: 22 Nm (16 lbf ft)
- 20 Remove the lock pin in the gearbox and press the plastic plug into the hole.
- 21 Remove the lock pin in the gear shift housing.
- 22 Fit the gear lever boot.
- 23 Try changing gear and see if the gear lock works.

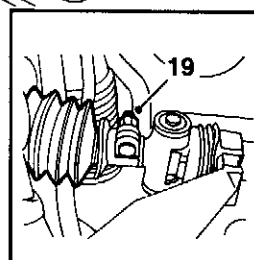
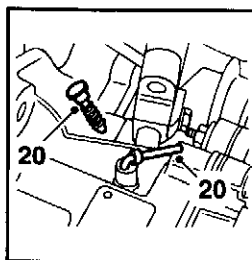
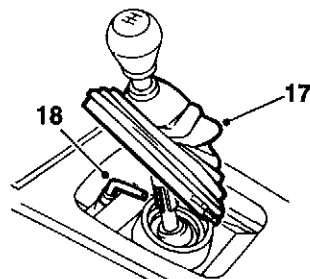

D432B620

Procedure

- 1 Place the car on a lift.
- 2 Engage 4th gear.
- 3 Remove the plastic plug on the gearbox and insert lock pin 87 92 335 (with the ring up) to lock the gearbox in 4th gear.
- 4 Undo the nut securing the gear rod to the linkage in the gearbox. Use a 13 mm spanner.

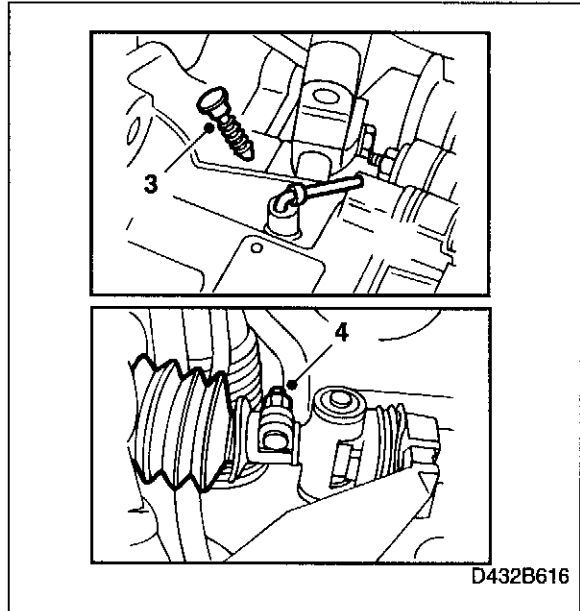

- 5 Move the gear lever to 3rd gear position so that the gear rod slides out of the linkage. Remove the screw securing the linkage to the gearbox.
- 6 Raise the car.
- 7 Remove the gear linkage.

