

9-5 ECU SWAP

Removing the box

The ecu is located underhood on the passengers right side of the car. As long as it is warm you do not need to remove the wiper arms. Rivet (item 4) needs to be removed. The Cowl plate can be removed by gently pulling it down away from the windshield. (There are clips that will break if you pull it off the windshield.) The free end can be hooked on the hood hinge to keep it out of the way.

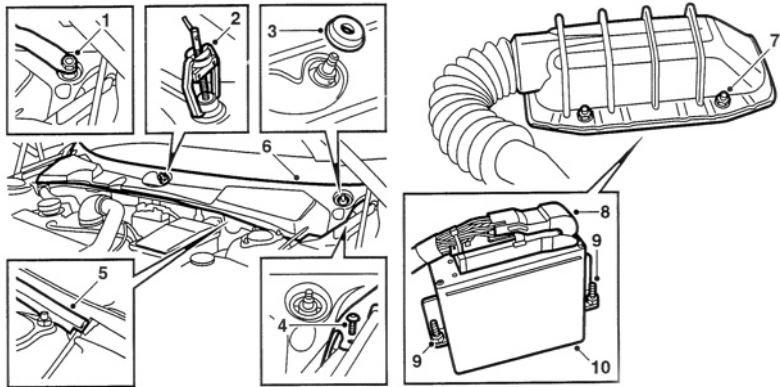

Next you need to remove the 4 10mm hex nuts that hold down the rubber boot of the weather proofing (Item 7) the rear two are a bit hidden. Be careful to not chip the edge of the windshield with the ratchet. Once loosened the boot can be slid up the wire harness to give necessary room. (Image to the right) Remove the electrical connector by lifting the lock lever up and to the drivers side.



The two nuts that hold the ECU in place (9) will usually require a deeper 10mm socket. Use a magnet to lift the nuts out. If you drop one tap on the trim panel above the passengers feet. It will usually fall right out onto the floor.

When replacing the ecu be sure to bolt it in the right way round to that the electrical connector will fit.

Reading the box

In regards to the Connector number (Image to the right) also know as Immobilizer code. Make sure to notice the difference between the o and 0 zeros have the slash. Then fill out the form on the website. If you are installing the tuned box now is the time to add the fuel regulator.



<http://www.genuinesaab.com/ecuform.htm>