

**Brake disc, front wheel****Removal**

1. Lift the car and take off the wheel.
2. Press the brake piston back with a pair of grips.
3. Remove the two brake caliper securing bolts. Bind the brake caliper to the spring strut using a cable tie.
4. Remove the brake disc lock screw and take off the brake disc.

**Fitting**

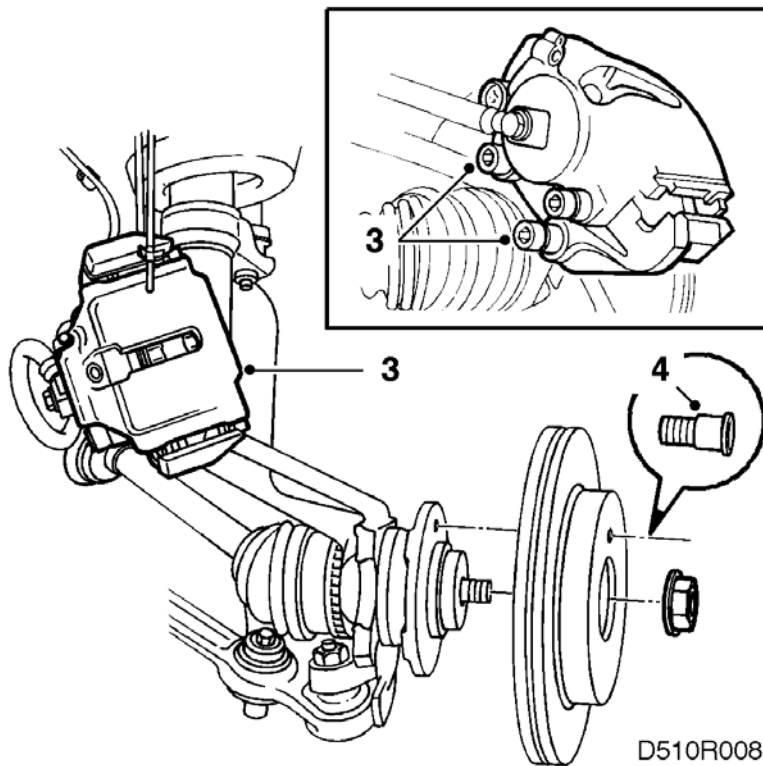
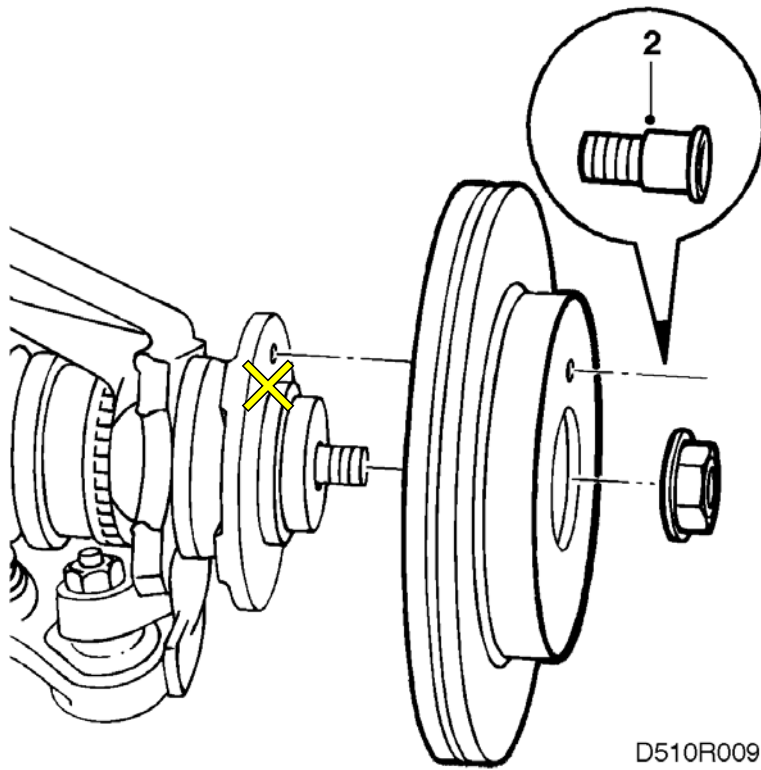

1. Before starting: Wash the new brake disc and check that the contact plane of the brake disc on the hub is free from corrosion and burrs etc.
2. Check that the area of the hub in contact with the brake disc is not corroded or dirty when the brake disc is fitted. Place the brake disc on the hub and tighten up the securing bolts using a locking compound.

**Tightening torque 4 Nm (3 lbf ft)**

- 3.

Fit the brake caliper, apply thread locking compound and tighten the bolts.

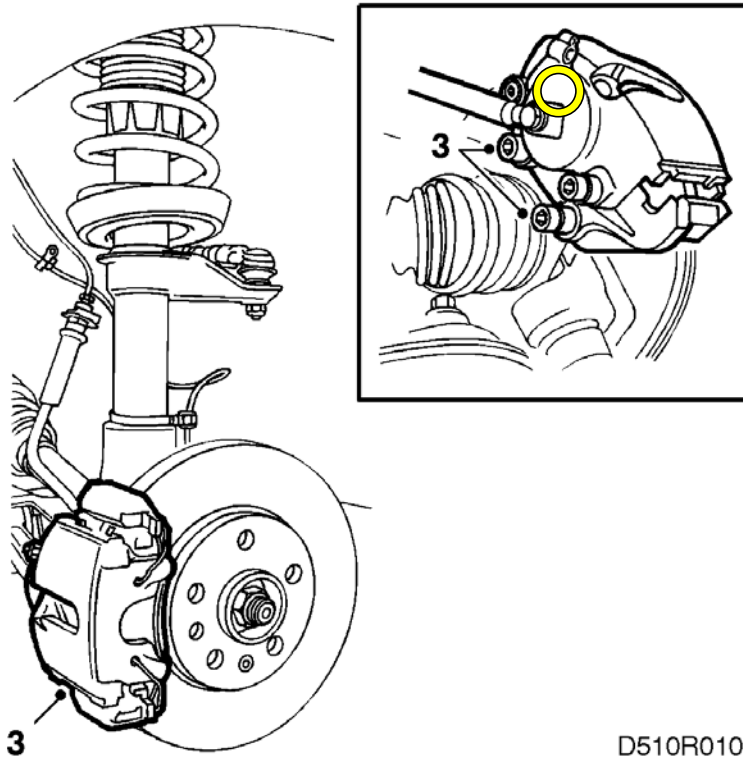

D510R010

**Tightening torque 118 Nm (87 lbf ft)**

4. Fit the wheel.

**Tightening torque**

- light alloy wheels 117 Nm (86.6 lbf ft)
- pressed steel wheels 100 Nm (74 lbf ft)

Lower the car and stamp on the brake pedal to force out the brake pads. Test drive the car and check the brake operation.